

2 BOX RANCH: PLAN NOTES

- 1. WINDOWS HEIGHTS SHOWN ON THIS PLAN ARE FOR 8' FLAT CEILINGS.
- 2. DOOR AND WINDOW HEIGHTS FOR 9' FLAT CEILING ARE LISTED BELOW.

8' CEILING	9' CEILING
60" WINDOW	72" TALL
36" WINDOW	48" TALL
18" WINDOW	30" TALL
6'-8" S.G.D.	6'-8" or 8'-0" S.G.D.

GENERAL NOTES

- 1. TRANSOMS ABOVE DELUXE ENTRY SYSTEMS ARE ONLY AVAILABLE W/ 9' FLAT CEILINGS.

ABBREVIATIONS

- P = PANTRY
- OH = OVERHEAD CABINET
- DBL S/R = DOUBLE SHELF AND ROD
- SGL S/R = SINGLE SHELF AND ROD
- E/P = ELECTRICAL PANEL
- DW = DISHWASHER
- W = WASHER
- D = DRYER
- WH = WATER HEATER
- FAU = FORCED AIR UNIT
- SGD = SLIDING GLASS DOOR

SALES ORDER SYMBOLS

- (GFI) GFI RECEPTAL
- (GFI/E) GFI IN EAIVE
- (#) ORDER NUMBER
- (HB) FROST FREE HOSE BIB
- (R) RECESSED CAN LIGHT
- (P) PENDANT LIGHT
- (TV/PH) TV/PHONE RECEPTAL
- (PH) PHONE JACK
- (SW) SWITCH LOCATION
- (W&C) WIRE AND CAP
- (W&B) WIRE & BRACE FOR FAN

FLOOR COVERINGS

- [Pattern] LINOLEUM
- [Pattern] TILE

WALL TYPES

- [Pattern] FULL HEIGHT WALL
- [Pattern] NON-FULL HEIGHT WALL

AREA SCHEDULE	
Level	Square Feet
L1-Deck	1517 SF

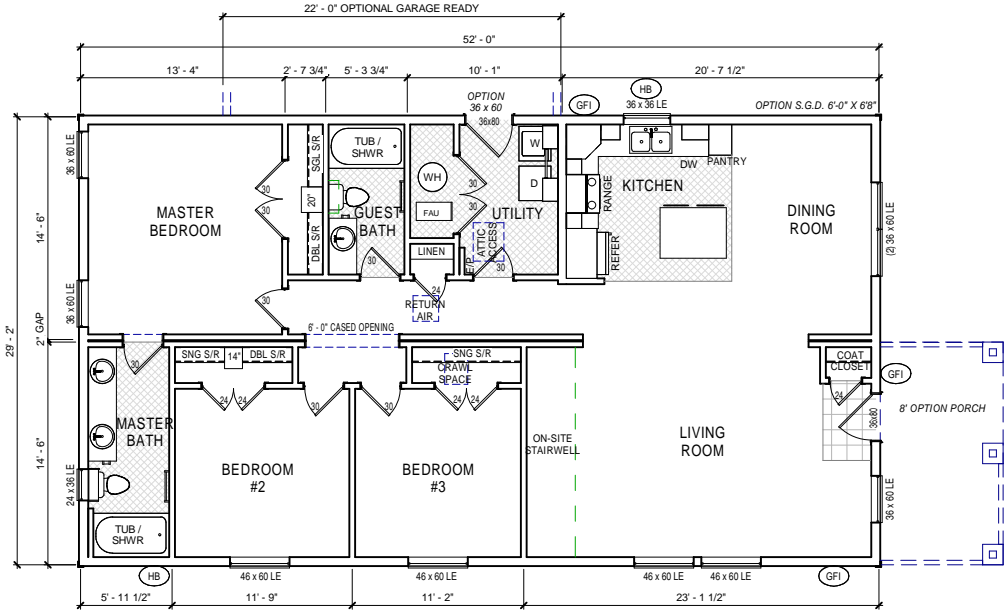

L1-Sales Floor Plan
N.T.S.



5556 FEDERAL WAY
BOISE, ID 83716

GUERDON ENTERPRISES, LLC, (GUERDON HOMES), CLAIMS EXCLUSIVE RIGHTS TO ALL INFORMATION, INCLUDING ALL CONCEPTS AND CONVENTIONS, CONTAINED IN THESE DRAWINGS. THE INFORMATION CONTAINED IN THESE DRAWINGS SHALL BE HELD CONFIDENTIAL AND CANNOT BE DISCLOSED TO ANY OTHER PERSON OR ENTITY WITHOUT THE EXPRESS WRITTEN CONSENT OF GUERDON ENTERPRISES, LLC. THESE DRAWINGS MAY NOT BE REPRODUCED, MODIFIED, OR DISTRIBUTED IN ANY FORM FOR ANY REASON WITHOUT EXPRESS WRITTEN PERMISSION FROM GUERDON ENTERPRISES, LLC. COPYRIGHT C 2007

Project Name/Number:
2R-3052-01 - SERIAL #

State:
STATE

Project Status:
PRELIMINARY

Client Name:
CUSTOMER

Project Address:
**STREET ADDRESS
CITY, STATE**

REVISION SCHEDULE	
REV #	TITLE

Sheet Title:
SALES FLOOR PLAN

Standard Module/Detail #:

Current Revision:

Project Engineer:
ENGINEER

Scale:
1/8" = 1'-0"

Sheet Number:
S-FP

Drawn By:
Author

Print Scale:
3/12" x 11" Print Scale:
N.T.S.